

# APOLLON

## TEMPERATURE HANDLER FOR GYROS AND LOW-G ACCELEROMETERS



**Apollon handler is fully automatic,** intelligent combination of 2-axis turning unit and loader specially designed for gyro and low-g accelerometer testing over temperature. Apollon has a soak track for up to 10 magazines inside the temperature chamber which enables very long temperature soak times.

**Noiseless testing conditions.** The turning unit is mechanically separated from the rest of the handler and its servo motors can be switched off in static positions (accelerometer testing). The mechanical structure of the handler enables testing of leadframe/strip in ANY orientation.

**Best possible testing results** and contact positioning are achieved through two step active alignment and continuous tracking of turning unit positioning. Every sensor axis can be yaw-rate stimulated individually. Apollon also involves very fast and simple test head change.

**AFORE**  
Meant for MEMS

# APOLLON

## TEMPERATURE HANDLER FOR GYROS AND LOW-G ACCELEROMETERS

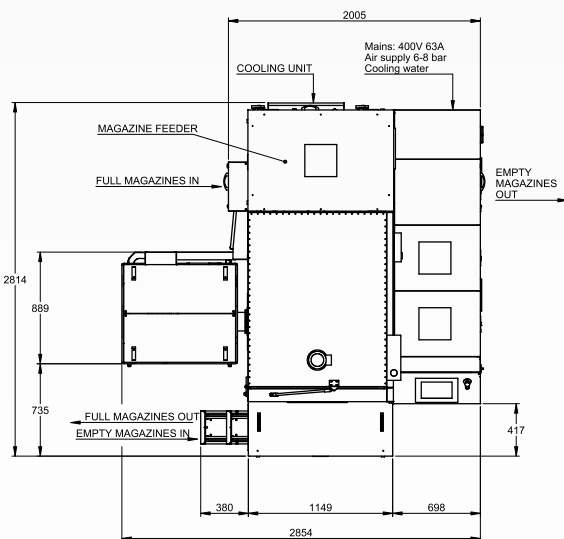
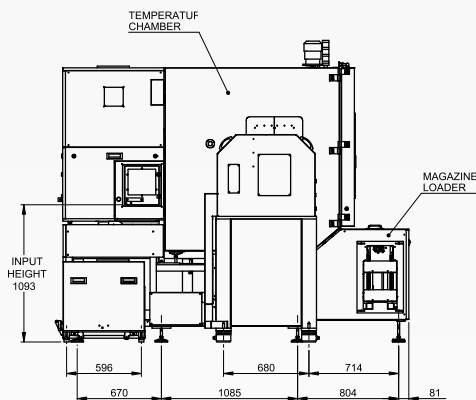
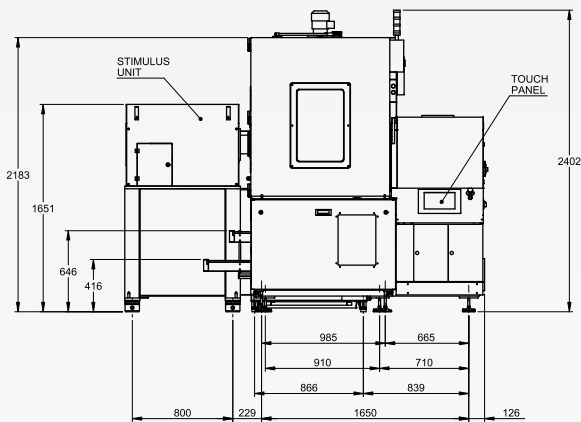

### HANDLER MECHANICS

1. axis	0...360°
2. axis	0...360°
Yaw rate:	
1. axis	30–300°/s (others by request)
2. axis	30–300°/s (others by request)
Yaw rate accuracy	typical <0,4% from actual rate
Positioning accuracy	<0,2° (includes product positioning), repeatability <0,05°
Temperature range	-50°C - + 150°C
Temperature accuracy	Testing nest ±1°C, soak track ±3°C
Leadframe width	max 35 mm
Leadframe length	max 200 mm
Strip change time	<11 s
Soak track capacity	up to 10 magazines per request
Contacting system	

### CONTROL SYSTEM

User interface	12" colour touch panel
Communication	Ethernet, ASCII-prompt protocol for easy communication with LabView or similar

### INFRASTRUCTURE

Weight	ca. 2000 kg
Pressure	6 Bar
Power	400 V / 63 A, 3-phase

### OPTIONS

- Strip ID code reader before and/or after testing
- Magazine ID code reader before and/or after testing
- Multiple leadframes parallel